



2012

Inventory Reduction Event

Autumn Woods

more details...

HECHT
Development 
hechtdevelopment.com



704-809-2500 or 704-489-1183
info@hechtdevelopment.com
A HECHT Development Neighborhood



Autumn Woods

Community Info

- Country feel, but minutes from the new Highway 16 - convenient to Charlotte!
- East Lincoln County Location
- Bring your own builder and plans!
- Architectural Review
- 50 lots on 118 acres
- Lot sizes from one acre to 4.5 acres
- Lots designed to afford the most privacy possible
- Boat/RV Storage included at no cost

General Info

- Minimum Square Feet to Build: 2,300 sqft
- Individual Well and Septic
- Boat or RV Storage Included at No Cost

- Owner Association Dues 2012:
\$847 Annual to maintain entrance and common areas
- Schools:
St. James Elementary
East Lincoln Middle
East Lincoln High
- Financing:
Special financing offered thru Peoples Bank. Please contact Mark or Rhonda with Peoples Bank at 704-489-8940.
Rfleming@peoplesbanknc.com
- Directions: From the intersection of Hwy. 16 and 73, go west on Hwy. 73 approximately 2 miles to Ingleside Farm Road. Turn right, then left at stop sign and continue to Autumn Woods.
- For Architectural Review, well and septic questions please call Bob Hecht at 704-634-4444.
- For lot plats, Covenants Conditions and Restrictions and Architectural Landscape Guidelines please visit hechtdevelopment.com

Please Call 704-809-2500 for more details and questions.

HECHT
Development

www.hechtdevelopment.com
A HECHT Development Neighborhood



Autumn Woods

Price List

Lot#	Dimensions							Acreage	Price	MLS
	Road									
3	166	X	395	X	194	X	439	1.66	\$45,000	883086
7	131	X	1053	X	253	X	1149	4.61	\$43,500	849104
8	120	X	1149	X	571	X	646	4.01	\$43,500	883077
13	121	X	373	X	121	X	376	1.04	\$36,000	849096
15	145	X	345	X	135	X	308	1.01	\$36,000	849078
17	52	X	714	X	342	X	644	4.10	\$58,000	883084
19	119	X	309	X	208	X	388	1.23	\$42,500	849082
20	120	X	388	X	218	X	442	1.60	\$42,500	883090
21	140	X	442	X	207	X	499	1.81	\$42,500	849109
22	135	X	499	X	209	X	453	1.82	\$42,500	849085
23	186	X	453	X	172	X	464	1.83	\$42,500	849092
24	212	X	464	X	156	X	443	1.92	\$41,900	849094
25	202	X	443	X	157	X	373	1.67	\$41,900	849095
26	594	X	373	X		X	472	2.58	\$39,500	883082
27	92	X	284	X	171	X	374	1.35	\$38,500	849114
28	187	X	374	X	158	X	390	1.51	\$38,500	849119
29	168	X	390	X	161	X	408	1.51	\$29,900	849127
31	157	X	435	X	468	X	543	3.24	\$48,500	849128
32	507	X	543	X		X	478	2.91	\$49,500	849282
34	150	X	464	X	154	X	426	1.53	\$54,500	849132
35	150	X	426	X	154	X	382	1.40	\$54,500	2076458
36	83	X	382	X	411	X	490	2.06	\$63,500	2076505
38	46	X	485	X	466	X	449	2.44	\$64,800	849262
41	152	X	757	X	270	X	572	2.62	\$54,500	849296
42	150	X	572	X	337	X	360	2.18	\$54,500	849278
44	192	X	271	X	271	X	237	1.31	\$42,900	883088
45	195	X	237	X	254	X	281	1.30	\$42,900	883089
46	184	X	283	X	231	X	415	1.81	\$36,000	849269
47	322	X	415	X	206	X	442	2.38	PENDING	PENDING
48	182	X	443	X	182	X	443	1.85	\$35,900	849272
49	143	X	443	X	215	X	460	1.83	\$35,900	849274
50	149	X	460	X	317	X	450	2.65	\$37,900	849276

NOTE: Dimensions & Acreage are approximate - please see lot enlargements for actual figures.
Prices subject to change. 5-4-12.



PRELIMINARY SURVEY
FOR

Autumn Woods

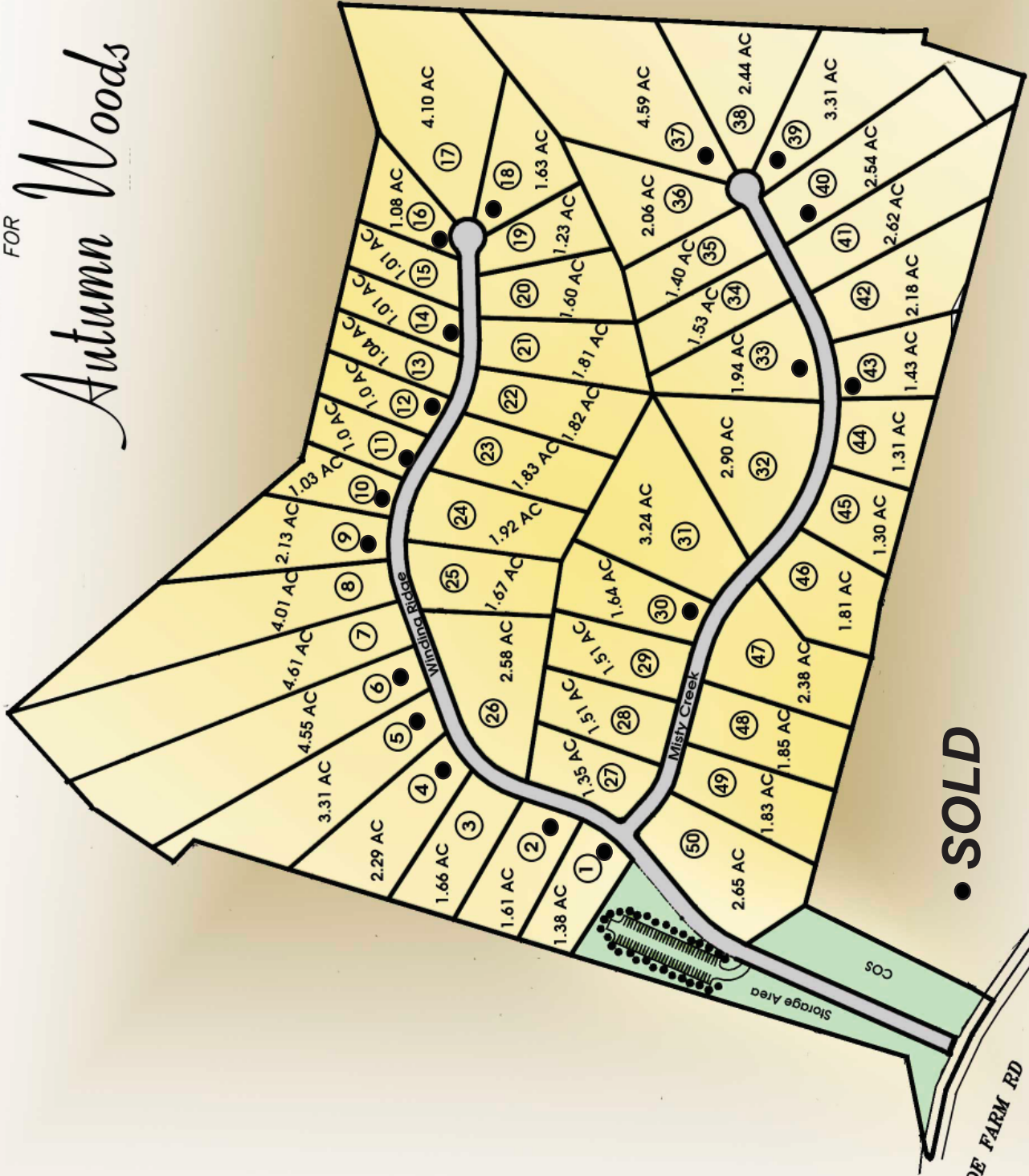

• **SOLD**

INGLESIDE FARM RD

NEW PRICING

New Homes



Scan with your
Smartphone



3326 CAYTON DRIVE, WYNSWEPT

Just completed and ready for you! Two story living room, formal dining, four bedrooms and large bonus room, granite in kitchen. Main level owner suite. \$264,900. Carolina MLS 981498 or Catawba MLS 9556145



3348 CAYTON DRIVE, WYNSWEPT

Craftsman style ranch with large bonus room. Front and rear porch and just 2 miles from the four-lane Hwy. 16 bypass into Charlotte. \$249,900. Carolina MLS 970213 or Catawba MLS 9555951



3331 CAYTON DRIVE, WYNSWEPT

Brick transitional with lots of upgrades. Energy Star Qualified. 3 bedroom plus bonus, built-in cabinetry, surround sound, and just 2 miles from the four-lane Hwy. 16 bypass into Charlotte. \$295,000. Carolina MLS 935669 or Catawba MLS 9552678



4142 MINERAL LANE, MINERS CREEK

Four bedrooms plus large bonus room in this 1 1/2 story home on wood deck. North Lincoln schools. Selling as is including closing costs. \$286,000. Carolina MLS 9560299

SOLD



Hecht Communities



Autumn Woods 3

- Iron Station in East Lincoln County
- Lot Size - 1 acre to 4.5 acres
- 50 lots on 118 acres
- Boat / Camper Storage
- Priced from \$29,900 to \$64,800



Fairfield Forest 4

- Denver in East Lincoln County
- Convenient to Golf, Swim & Tennis
- 50 Lot Community, Less than Half Remaining
- Sidewalks & Streetlights, Cty Water & Sewer
- Priced From \$24,500 to \$29,500



James Plantation 5

- Denver in East Lincoln County
- 3/4 Mile from Highway 16 Bypass
- 21 Lots , 1 to 4.5 Acres, Gated Entry
- Streetlights, County Water & Sewer
- Priced from \$19,500 to \$44,500



Kerns Meadow 2

- Huntersville in North Mecklenburg
- Lot Size - about 3/4 of an Acre
- Gated Entry 12 Lot Community
- ONLY 1 LOT REMAINING
- Priced at \$28,500



Killian Crossing 1

- Denver in East Lincoln County
- Lot Size - 1/2 Acre Plus
- Established Community, County Water
- Over 49 acres Common Open Space
- Priced from \$20,950 - \$26,250



WynSwept 6

- Maiden in S.E. Catawba County
- Lot Size - 3/4 acre to Over 2 Acres
- Two Miles from Highway 16 Bypass
- Priced from \$22,500
- New Homes Available

